

# Exhibit A: Location Map

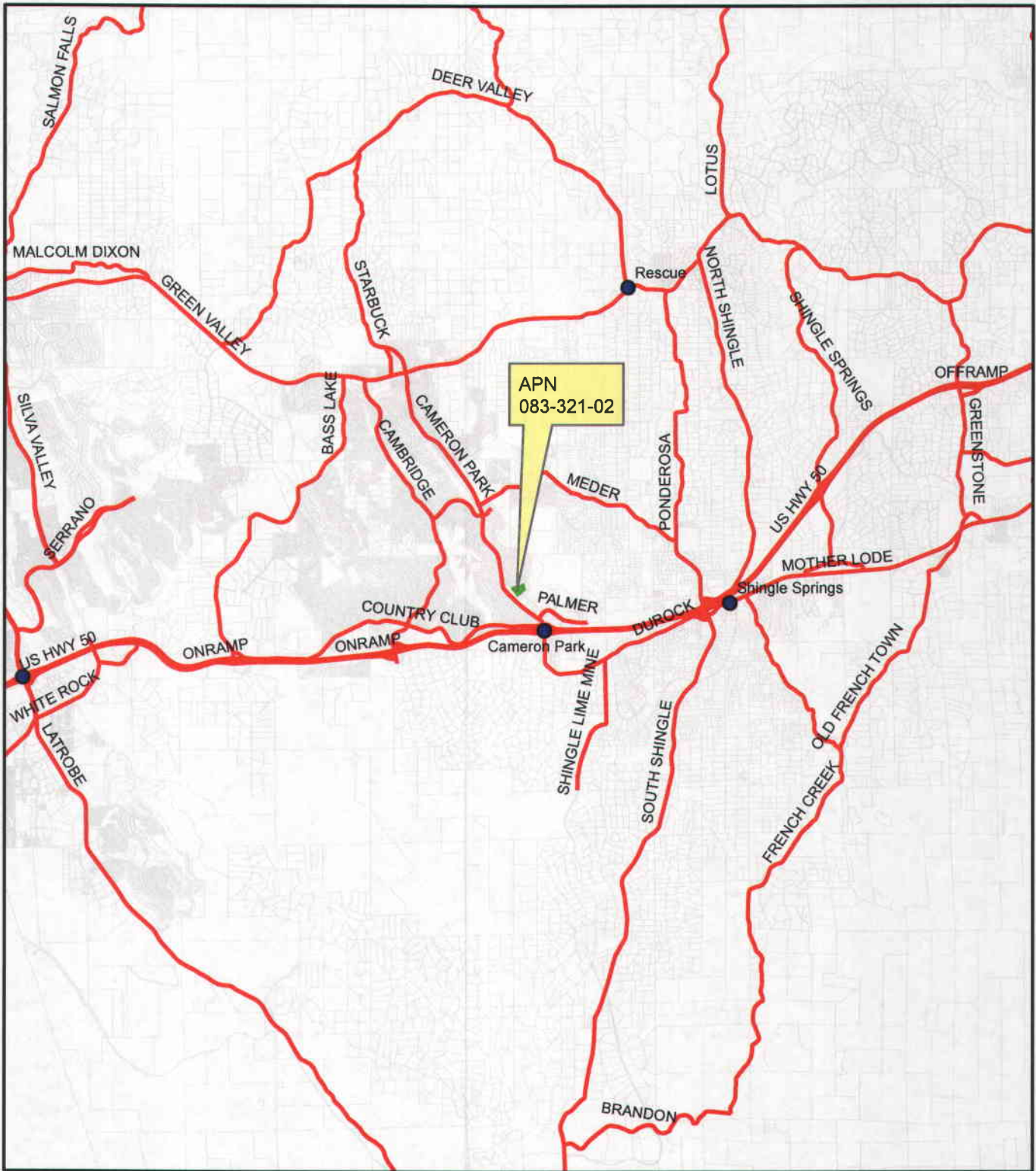

- PLACENAMES
- major\_roads
- currprcl



S80-0138-R-3/LDS Picnic Shelter  
Prepared By Aaron Mount

0 0.5 1 2 Miles

POR. SEC. 3, T.9N., R.9E., & POR SEC. 34, T.10N., R.9E., M.D.M.  
CAMERON PARK NORTH UNIT NO. 6

D-80

83:32

EXHIBIT B

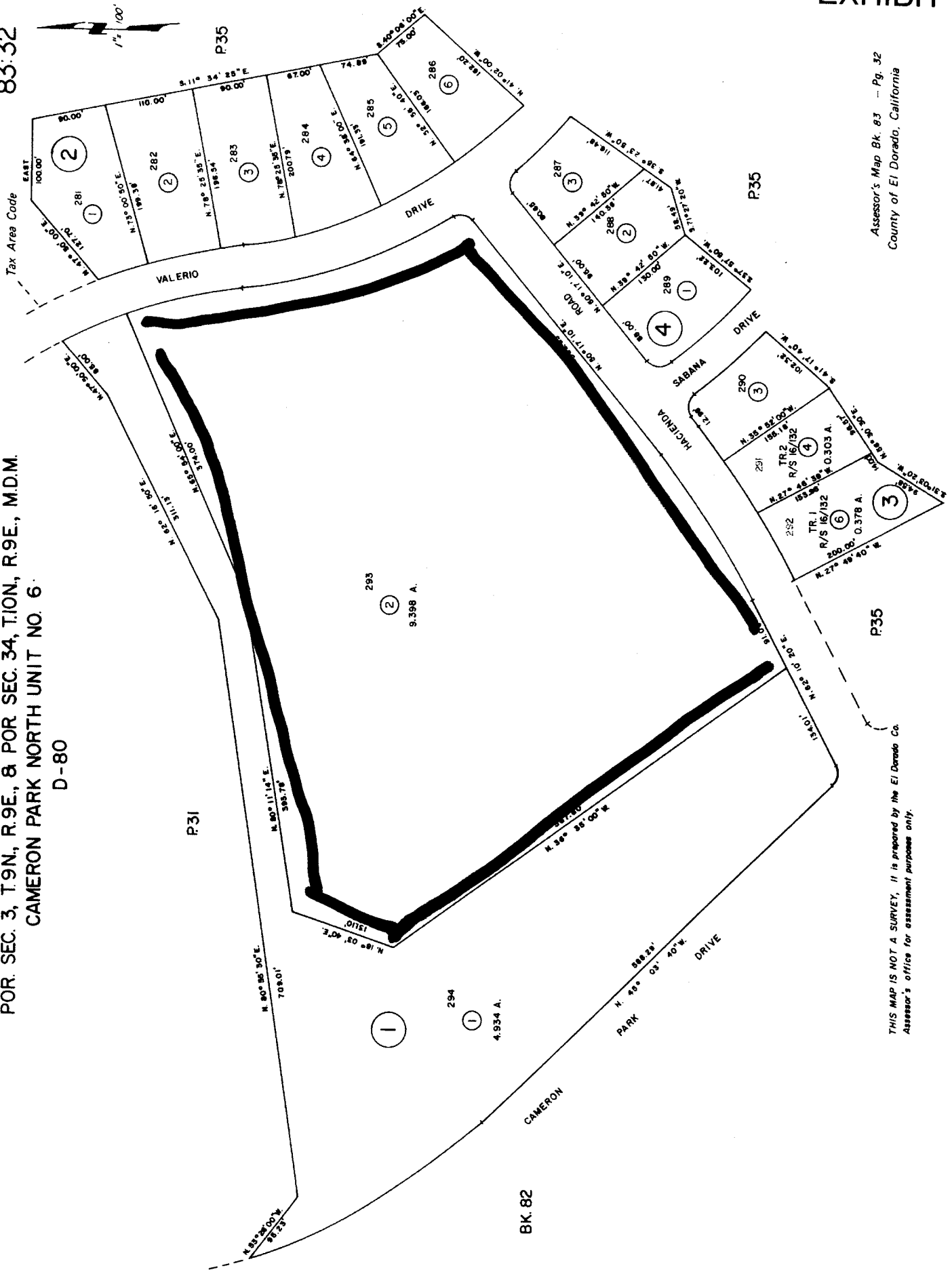



Assessor's Map Bk. 83 -- Pg. 32  
County of El Dorado, California

THIS MAP IS NOT A SURVEY, it is prepared by the El Dorado Co. Assessor's office for assessment purposes only.

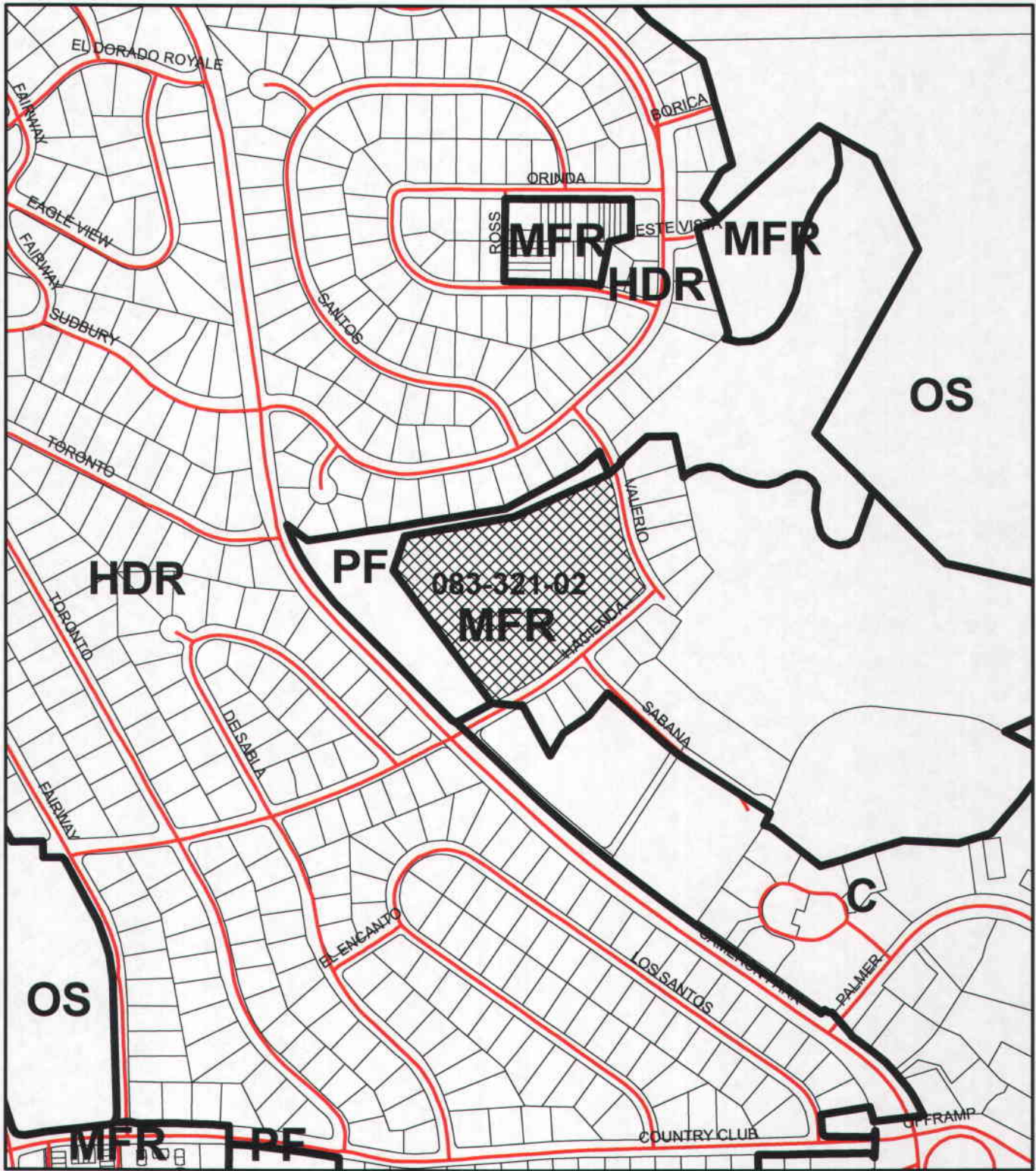
# Exhibit C: General Plan Map



	ludesign
	gpsroads
	currprcl



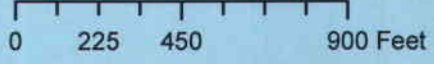

S80-0138-R-3/LDS Picnic Shelter  
Prepared By Aaron Mount

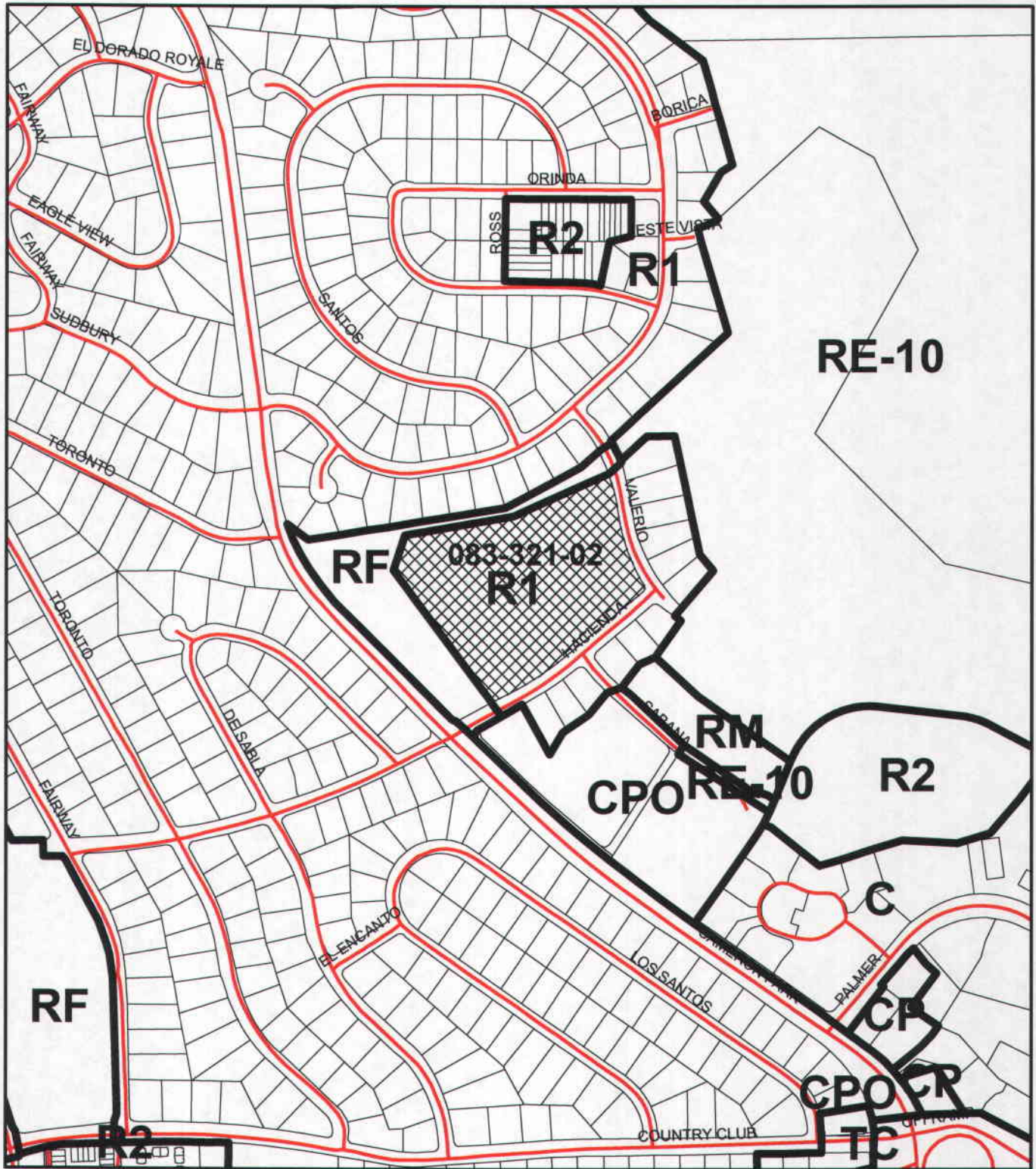

# Exhibit D: Zoning Map



 zones  
 gpsroads  
 currprcl



S80-0138-R-3/LDS Picnic Shelter  
 Prepared By Aaron Mount  

SHEET No. SD1:1

Drawn By	MLT
Checked By	JAN 23, 2019
Date Drawn	JAN 23, 2019
Scale	AS SHOWN
Job No.	12-3998

REVISITORS  
 Sym. Description By Date

DRAWING STATUS  
 PRELIMINARY DESIGN

SITE PLANS  
 FLOOR PLAN  
 ELEVATION

3481 HACENDA ROAD  
 CAMERON PARK, CALIFORNIA  
 LDB PROJ. # 822-0774

PROJECT NAME  
 A PROPOSED RECREATIONAL PICNIC SHELTER FOR EL DORADO CA STAKE



CONSULTANT  
 NICHOLS MELNYK ROSSETTO

1721 264 STREET, SUITE 200  
 SACRAMENTO, CALIFORNIA 95811  
 PHONE: (916) 987-1340  
 FAX: (916) 786-0094

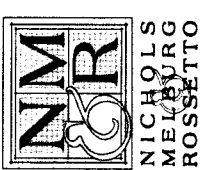

DATE: 12/20/18  
 PROJECT: EL DORADO CA STAKE  
 DRAWING: FLOOR PLAN  
 SHEET: SD1:1

19 JUN 23 AM 2:56

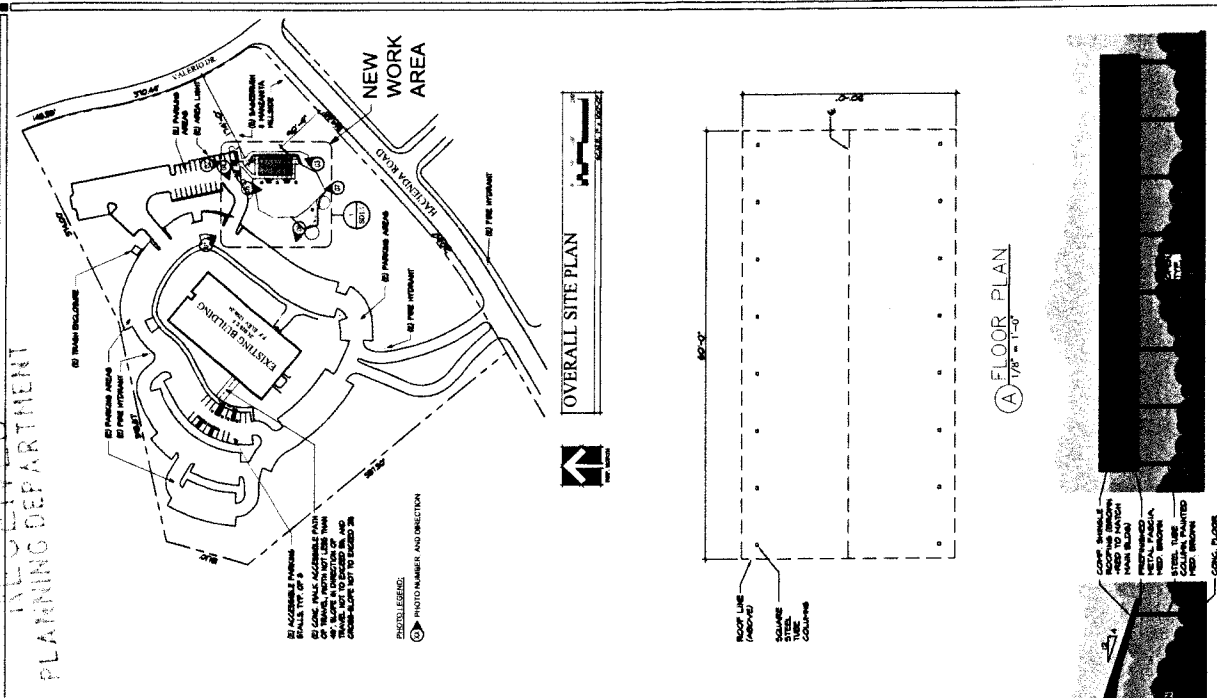

OVERALL SITE PLAN  
 SCALE: 1" = 20'-0"

FLOOR PLAN  
 SCALE: 1/8" = 1'-0"

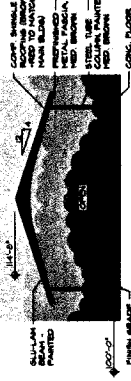

WEST ELEVATION (EAST SIM.)  
 SCALE: 1/8" = 1'-0"

SOUTH ELEVATION (NORTH SIM.)  
 SCALE: 1/8" = 1'-0"

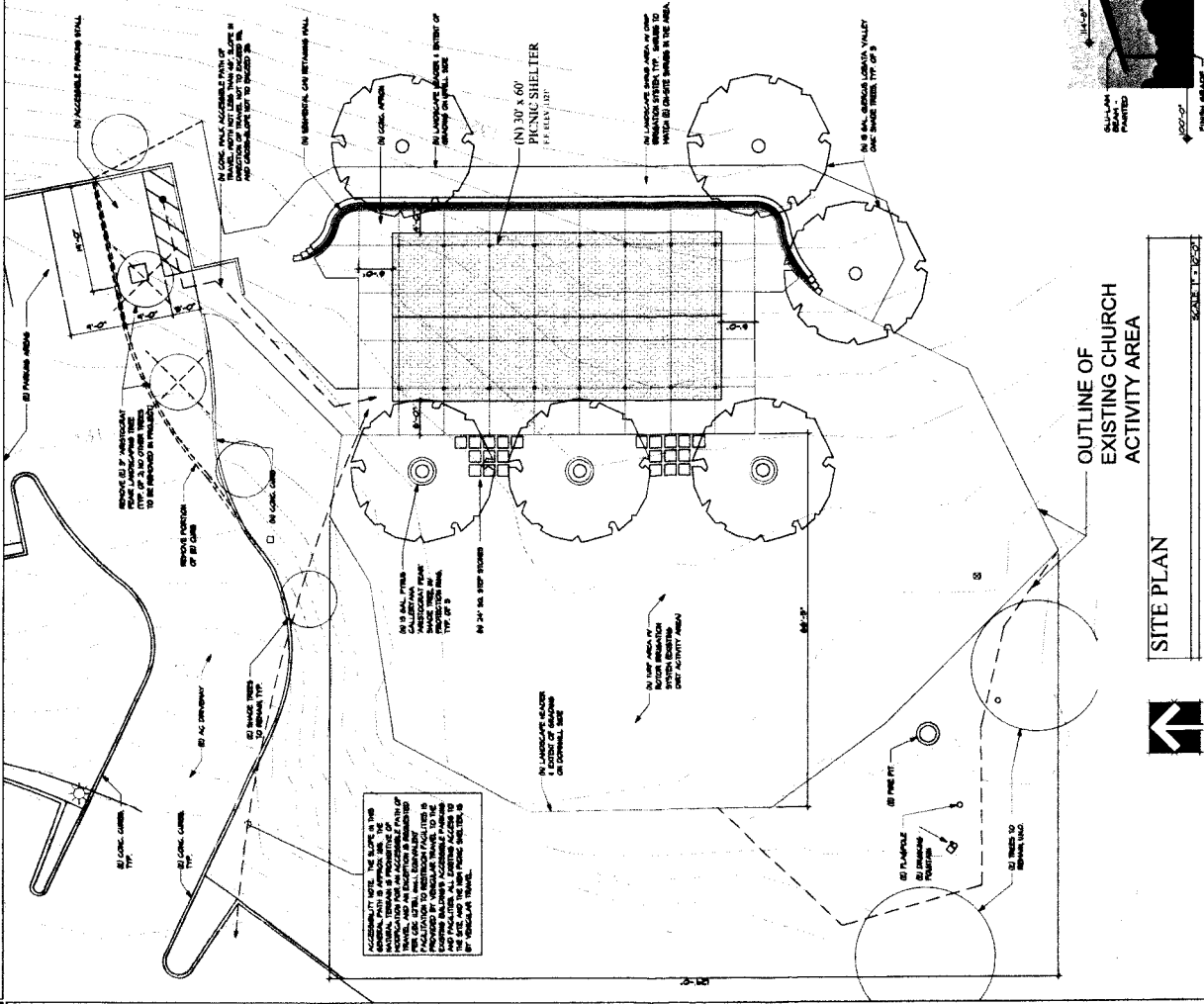

SITE PLAN  
 SCALE: 1" = 20'-0"

OUTLINE OF EXISTING CHURCH ACTIVITY AREA