

At Work, School or In Your Car

You may not be at home when an emergency occurs.

- Who will pick up/take care of your children and/or pets?
- How will you communicate?
- Keep your gas tank at least half full at all times.
- Keep extra supplies at work, at school, and in your car in case you cannot return home immediately.

Your Pets & Other Animals

- Identify pet-friendly locations to take your animals if you have to evacuate
- Identify a friend, neighbor or family member that can help you take care of your animals if you are unable to return to your home
- Microchip your pets and animals
- Have metal ID tags on all of your pets
- Be sure large animals are trained to get into a trailer
- Have food and water sources available if you need to evacuate without your animals

For More Information Visit:

El Dorado County Emergency Preparedness and Response

www.edcgov.us/preparedness

Find Us On Social Media: EDCPreparedness



El Dorado County Animal Services

www.edcgov.us/animalservices

Ready.gov

www.ready.gov/make-a-plan



Emergency Preparedness and Response is a program of the El Dorado County Health and Human Services Agency

El Dorado County
Emergency Preparedness and Response
2900 Fair Lane Court
Placerville, CA
(530) 621-7581

What Will You Do?



Tips to develop an Emergency Plan to keep yourself, your family and your pets safe in the event of an emergency

**El Dorado County
Emergency Preparedness
& Response**

Know Local Hazards

Learn to plan for potential emergencies in El Dorado County:

- Wildland fires
- Utility failures (power, water & communications systems)
- Floods
- Hazardous materials spills
- Infectious diseases, like pandemic flu

Know Your Neighbors

Your neighbors may be your “first responders” in an emergency. Get to know them and include them in your emergency planning.

Power Outage

Power outages can occur at anytime.

- Learn to use generators safely
- Have a cell phone car charger
- Identify back-up power for electricity-dependent medical equipment
- Identify safe sources of heat and light for your home



Make a Kit



Evacuation

Instructions issued by officials should be followed immediately to protect your safety.

- Identify at least 2 escape routes from locations where you spend your time
- Identify a meeting place if you and your family are separated
- Practice using your escape routes and meeting at the identified location
- Practice evacuating with your family, pets and animals, and neighbors

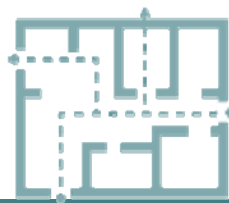

Have a Plan

Emergency Plan

Tear this section off and post where it can be found easily in your home, or keep it with you.

If we have to evacuate, we will meet at

Our pets/animals will go to

Our Emergency Kit is located

Our Fire Extinguisher is located

Utility Shut Offs are located



Be Informed